

dual purpose application series

Range Summary

Using oxygen recombination technology: maintenance-free
 PbCaSn alloy for plate grids: low self discharge rate than 3% per month
 High quality AGM separator: extend cycle life and prevent micro short circuit retardant
 High purity raw material: 99.99% pure lead



Application

Cable Television
 Communication
 Equipment
 Security System

UPS
 Control Equipment
 Medical Equipment
 Emergency Power



Battery Dimensions

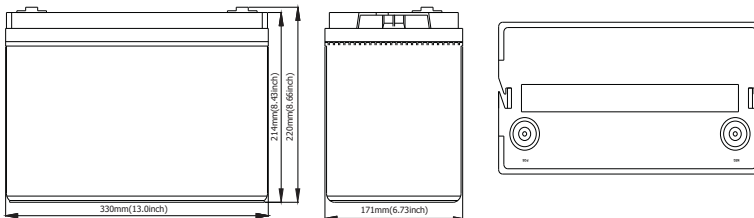

Terminal Dimensions

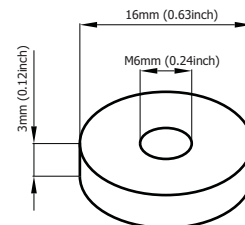

Technical Specifications

Battery Model	NPCDP12-135			
Designed Floating Life	12 Years			
Capacity(20°C)	20HR(7.15A,1.80V)	10HR(13.5A,1.80V)	5HR(25.3A,1.75V)	1HR(89.1A,1.60V)
	143Ah	135Ah	127Ah	89.1Ah
Dimensions	Length	Width	Height	Total Height
	330mm(13.0inch)	171mm(6.73inch)	214mm(8.43inch)	220mm(8.66inch)
Approx. Weight	34.5Kg (75.9 lbs)			
Internal Resistance	Full charged at 20°C: 0.0038 Ohm			
CCA	1000			
Capacity Affected by Temp.(10HR)	40°C	20°C	0°C	-15°C
	109%	100%	85%	65%
Charge Voltage(20°C)	Cycle use		Float use	
	14.4-14.8V(-30mV/ °C), max. Current: 33.75A		13.6-13.8V(-18mV/ °C)	

dual purpose application series

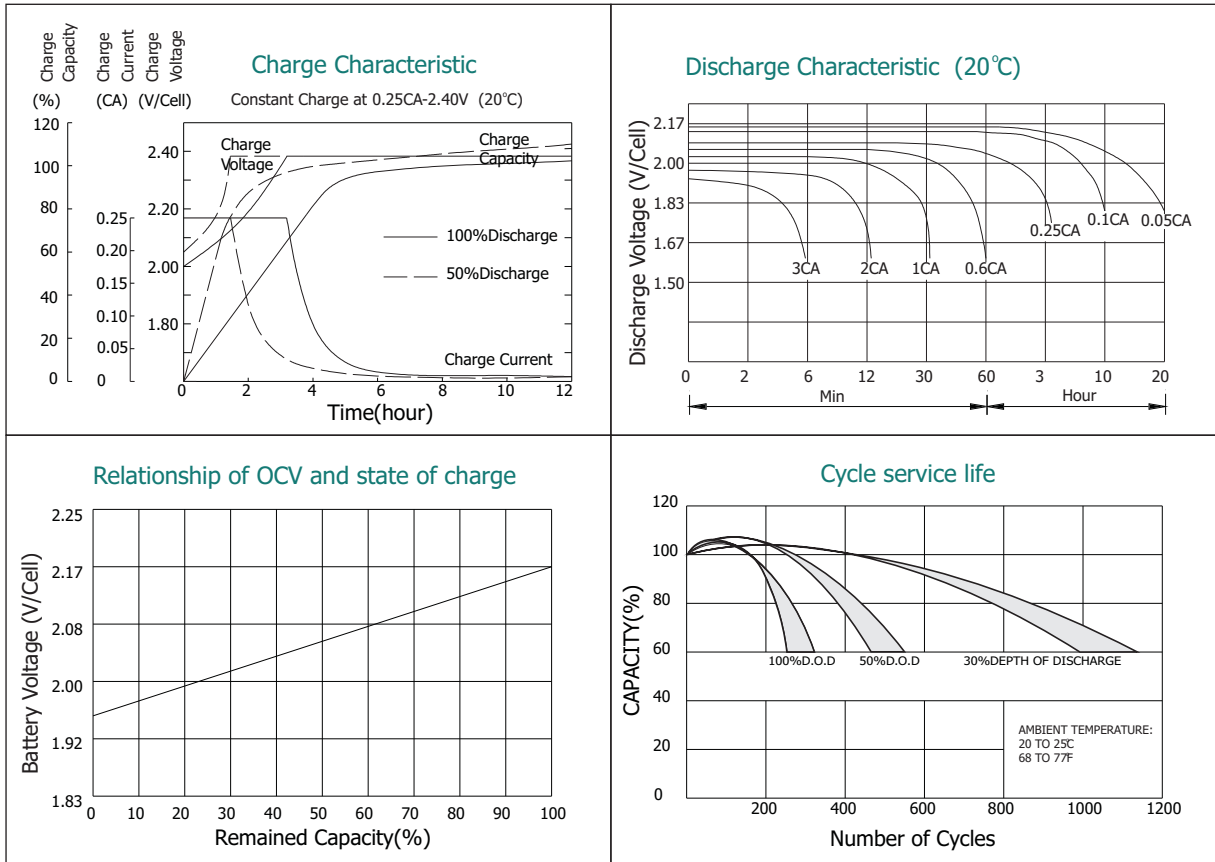

Constant current discharge ratings-amperes at 20°C

F.V/Time	5min	10min	15min	30min	1h	3h	5h	10h	20h
1.60V	473	324	236	142	89.1	36.9	25.8	14.3	7.47
1.67V	425	296	230	138	88.9	36.8	25.6	14.1	7.44
1.70V	404	285	221	135	88.7	36.7	25.5	14.0	7.40
1.75V	359	263	209	132	87.8	36.5	25.3	13.8	7.28
1.80V	324	244	200	128	86.7	36.3	25.1	13.5	7.15
1.85V	246	201	173	118	85.7	36.2	24.9	13.3	6.72

Constant power discharge ratings-watts at 20°C

F.V/Time	5min	10min	15min	30min	1h	3h	5h	10h	20h
1.60V	779	537	419	267	176	70.7	50.8	28.6	14.9
1.67V	738	531	414	262	170	70.4	50.6	28.2	14.8
1.70V	690	517	408	255	165	70.2	50.4	28.0	14.7
1.75V	643	483	383	248	164	69.7	50.2	27.5	14.5
1.80V	576	450	360	242	161	68.7	49.4	27.0	14.3
1.85V	462	373	315	221	159	68.4	48.7	26.5	13.4