

# START HERE!

## READ ME FIRST

Don't be a hero and muscle through this installation without reading these fitting instructions first! Improper installation of this gear may void certain aspects of your warranty.

Before you begin, take a moment and open all your Front Runner rack kit boxes and gather the assembly instructions for the various components.

A complete kit will contain:

1. A Front Runner Mounting System specific to your vehicle
2. A Front Runner Rack Tray or Load Bar Slats

This document will guide you through the assembly of the mounting system and assist you in fitting the roof rack tray or load bars to your specific vehicle.

Please refer to the next page for a list of all the components, quantities and tools required.

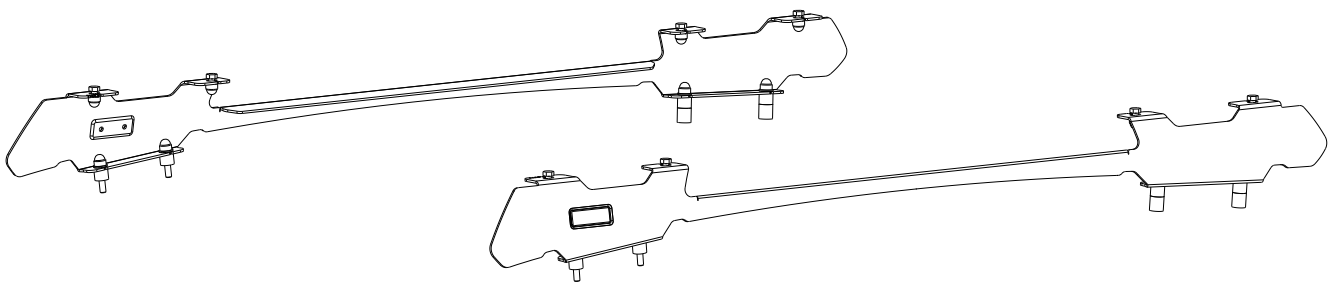

### IMPORTANT WARNING!

IT IS CRITICAL THAT ALL FRONT RUNNER PRODUCTS BE PROPERLY AND SECURELY ASSEMBLED AND ATTACHED TO YOUR VEHICLE. IMPROPER ATTACHMENT COULD RESULT IN AN AUTOMOBILE ACCIDENT, AND COULD CAUSE SERIOUS BODILY INJURY OR DEATH. YOU ARE RESPONSIBLE FOR ASSEMBLING AND SECURING ALL FRONT RUNNER PRODUCTS TO YOUR VEHICLE, CHECKING THE ATTACHMENTS PRIOR TO USE, AND PERIODICALLY INSPECTING THE PRODUCTS FOR ADJUSTMENT, WEAR AND DAMAGE. THEREFORE, YOU MUST READ AND UNDERSTAND ALL OF THE INSTRUCTIONS AND PRECAUTIONS SUPPLIED WITH YOUR FRONT RUNNER PRODUCT PRIOR TO INSTALLATION OR USE. IF YOU DO NOT UNDERSTAND ALL OF THE INSTRUCTIONS AND CAUTIONS, OR IF YOU HAVE NO MECHANICAL EXPERIENCE AND ARE NOT THOROUGHLY FAMILIAR WITH THE INSTALLATION PROCEDURES, YOU SHOULD HAVE THE PRODUCT INSTALLED BY A PROFESSIONAL INSTALLER OR OTHER QUALIFIED PERSONNEL.

**NOTE:** Front Runner will not be responsible for any damage caused by the failure to install the product according to these instructions.

Please call us if you have any questions about the installation of this product.

# 1

## GET ORGANIZED

### IN THE BOX

1	1 X	Foot Rail - 1LH + 1RH
2	16 X	M8 Nut Cap
3	8 X	M8 x 40 Hex Bolt
4	8 X	M8 Spring Washer
5	8 X	M8 x 19 x 2 Flat Washer
6	8 X	M8 x 20 Hex Bolt
7	8 X	M8 x 16 x 1.6SS Flat Washer
8	8 X	M8 Nyloc Nut
9	8 X	Spacer 15mm Long
10	4 X	Spacer 20mm Long

### TOOLS NEEDED

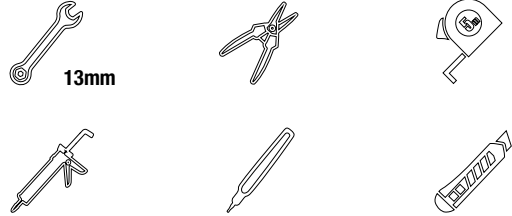
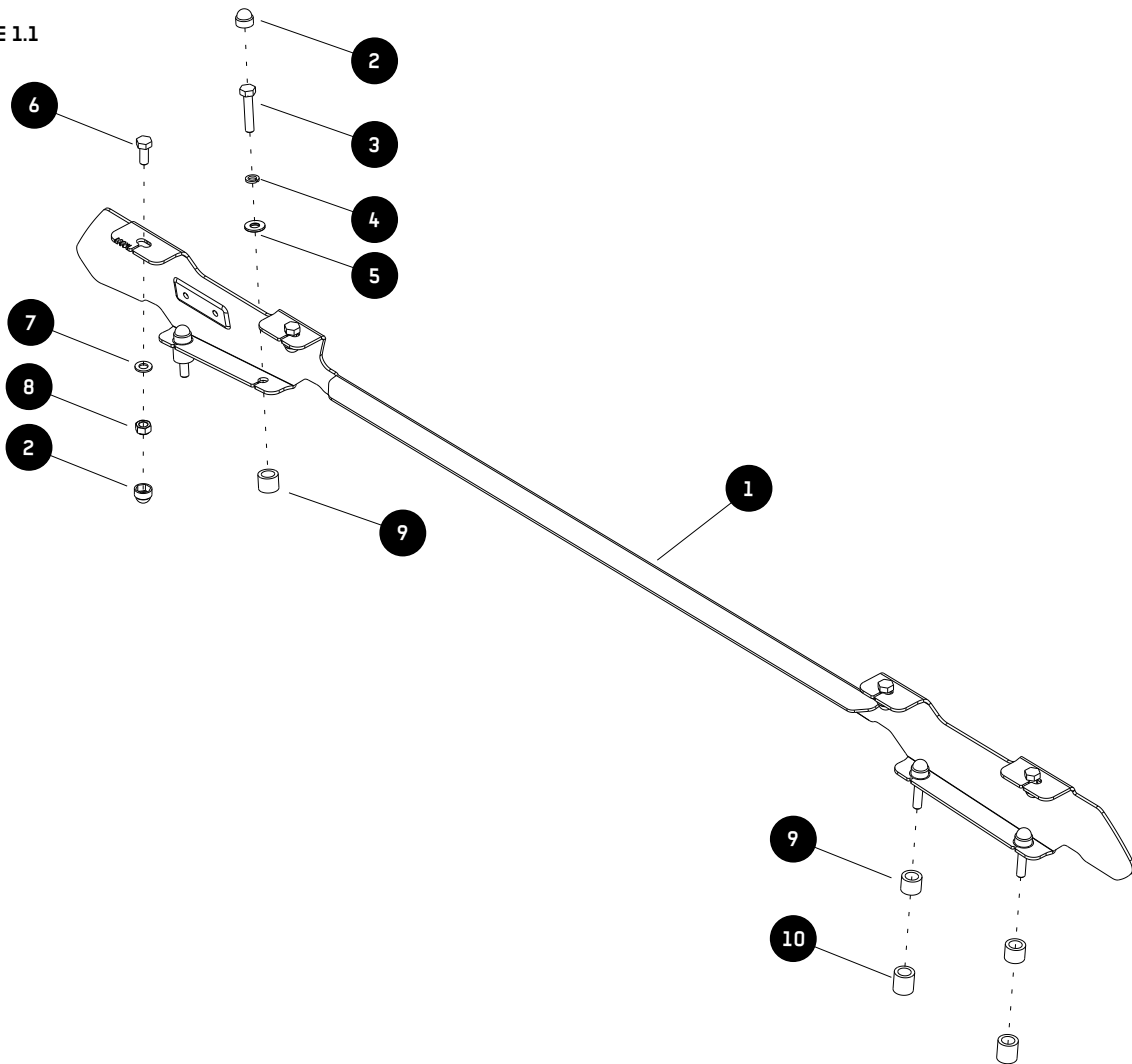
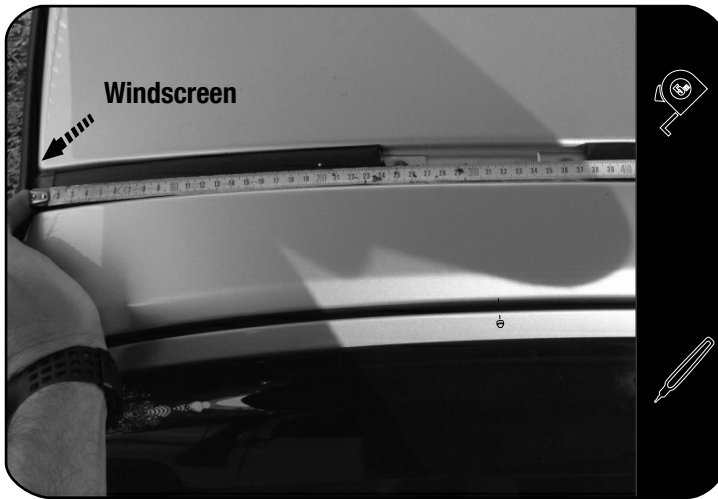

FIGURE 1.1



2.1



Starting at the front windscreen as shown, measure along the Ditch Moulding towards the rear of the vehicle. Mark the Ditch Moulding at the following distances 240mm and 375mm.

2.2



Still measuring from the front windscreen mark the Ditch Moulding at the following distances 1245 mm and 1410 mm.

2.3

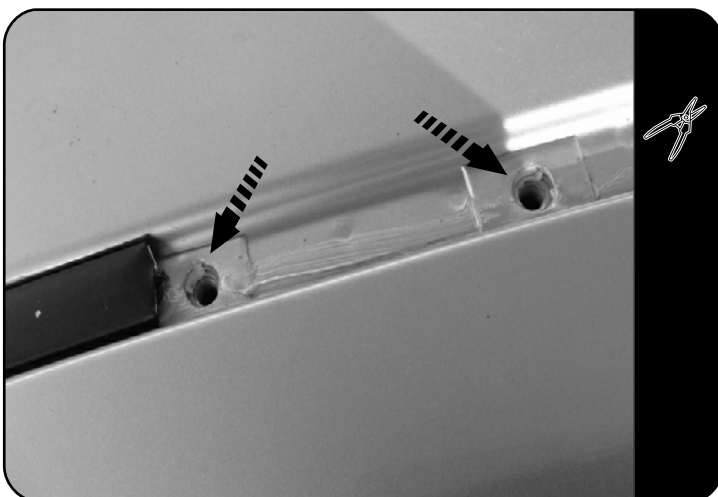

Using a pair of tin snips, cut the Ditch Moulding on each of your marks and remove the small strips of Ditch Moulding between markings 1-2 and 3-4.

Looking at the ditch, where you have just removed the Ditch Moulding, locate the two Threaded Mounting Points in the vehicle's roof and remove the Protective Tape covering them.

## FIT AND SECURE

2.4

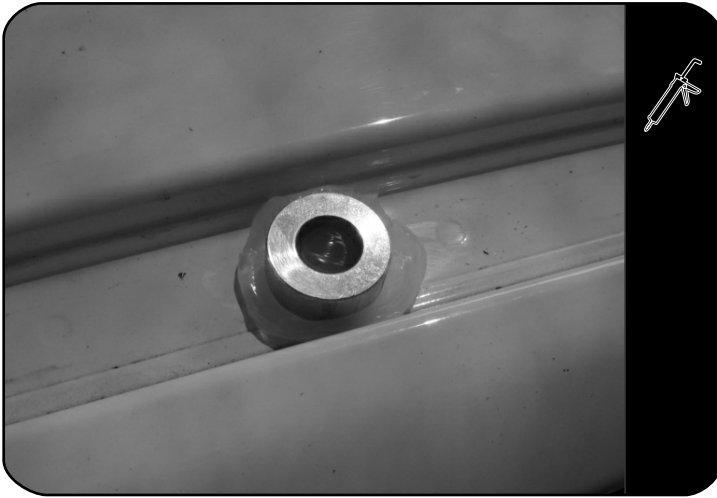

Put a small amount of silicone over each Mounting Point and placea Spacer (Item 9) on top of the Silicone, lining up the hole in the Spacer with the mounting point.

**Note:** For the 2015 to current vehicle models, the 20mm Spacers (Item 10) must be used at the rear mounting points.

2.5

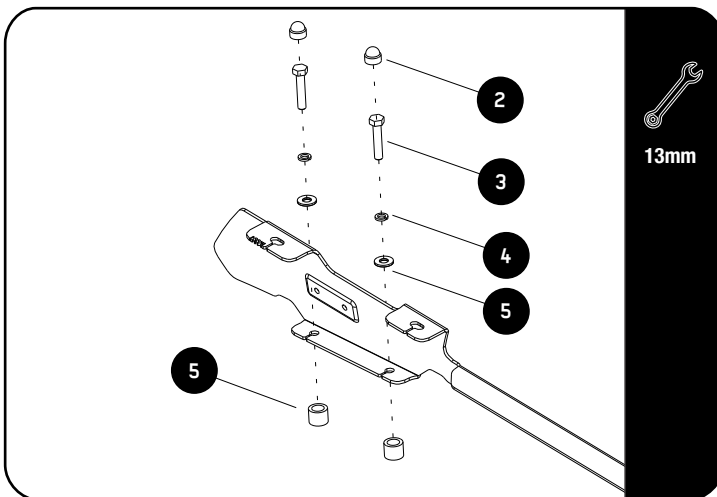

Place the Foot Rail (Item 1) onto the Spacers, aligning the holes in the base of the Foot Rail with the center of the Spacers. The product sticker goes to the front of the vehicle and must face outwards.

Secure the Foot Rail to the vehicle using the M8 x 40 Hex Bolts, M8 Spring Washers and M8 x 19 Flat Washers (Items 3, 4 & 5).

Do this on both left and right side of the vehicle.

### 3 FIT AND SECURE

3.1 Refer to RRSUNI when assembling your Slimline II Tray.

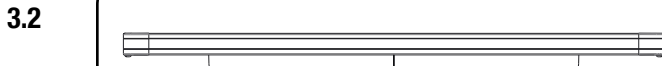

Make sure that the wind deflector is installed before you proceed to the next step.

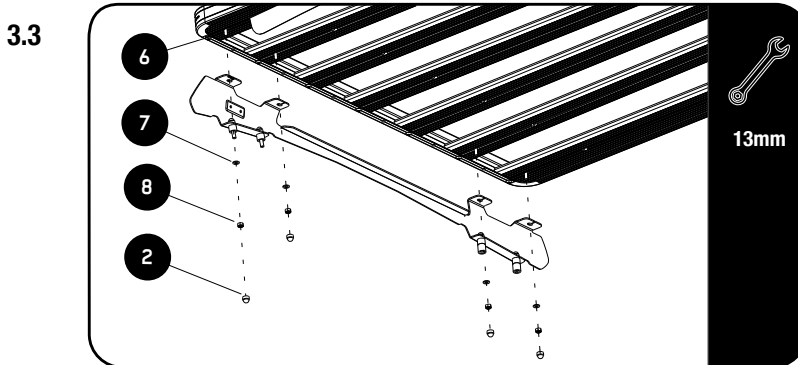

Fit your roof rack to the Foot Rails using M8 x 20 Hex Bolts, M8 x 16 x 1.6SS Flat Washers and M8 Nyloc Nuts (Items 6, 7 & 8) as shown.

3.4 Center the rack and tighten fully. Use M8 Nut Caps (Items 2) to finish off the nuts.



### 4 COMPLETION

4.1 Congratulations! You did it. Take a step back and admire your work!



### 5 INSTALL OTHER VEHICLE AND RACK ACCESSORIES

Now's the time to visit your favorite Front Runner Dealer in person or online.

#### IMPORTANT!

FRONT RUNNER RACK KITS OFTEN HAVE A HIGHER LOAD RATING THAN THE VEHICLES THEY ARE MOUNTED TO. PLEASE REFER TO YOUR SPECIFIC VEHICLE MANUFACTURER FOR A RECOMMENDED ROOF RATING. FRONT RUNNER CANNOT BE RESPONSIBLE FOR IMPROPER LOADING BEYOND THE VEHICLE MANUFACTURER'S STATED LOAD CAPACITY.

Be sure to tag us. We love to see our gear in action! #FrontRunnerOutfitters #BornToRoam

Share your adventures on: