

USER MANUAL

Thank you for choosing the EPower! Always follow basic safety precautions when using electrical appliances. Read all instructions carefully. Please keep this instruction manual for easy reference.

A.PRODUCT LAYOUT:

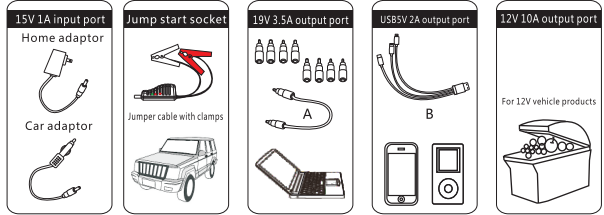
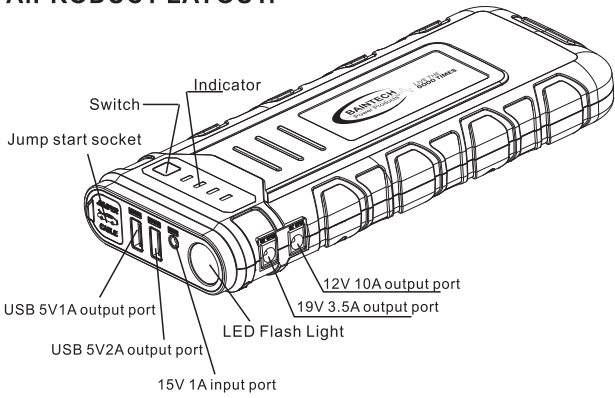

①

B.OPERATION GUIDANCE

Indicator

Press the switch to check the storage level of Epower.

Indicator	Unlit	1 solid	2 solid	3 solid	4 solid
Storage level	0%	25%	50%	75%	100%

The indicator will flash one by one during the period of charging. Different number of solid indicators show different storage level of EPower. All indicators light off when the charging is paused or completed.

EPower Charging Instruction :

1. Plug the home adaptor into the universal socket.
2. Connect 15V 1A input port of EPower to the other end of home adaptor .
- Or
1. Plug the car adaptor into the socket of cigarette lighter.
2. Connect 15V 1A input port of EPower to the other end of car adaptor.

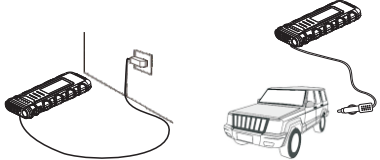

Jump start 12V vehicle Instruction:

- 1.Connect the blue plug fully seated into the host, and make sure the Cable Indicator is off.
- 2.Connect Red Clamp to the positive (+) battery terminal, Black Clamp to the negative (-) battery terminal.
- 3.Operate following the instruction of the Cable Indicator.

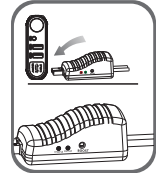

②

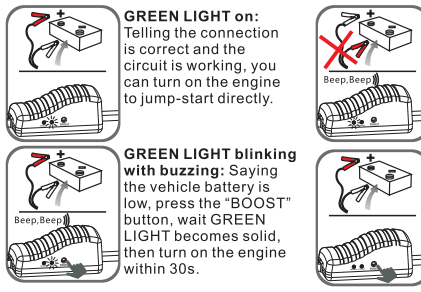

4. Start the vehicle.
5. When the vehicle is started, remove the jumper cable from the vehicle battery. Leave the vehicle's engine running.

Charging Cell Phone or Tablet Instruction:

1. Plug the switch cable B to USB 5V 2A output port.
2. Select appropriate connector and connect it to your mobile phones or tablet.
3. Press the switch button to charge.
- 4.If doesn't work, please try another USB Output port.



Only for charging/power supply to 19V Notebook

1. Plug the switch cable A to USB 19V 3.5A output port.
2. Select appropriate connector for your Notebook and connect it to the switch cable A and your Notebook.
3. Press the switch button to charge/power supply.

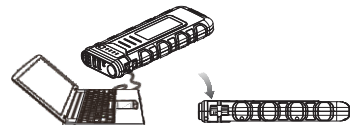

③

For power supply to 12V vehicle products or 12V electronics

1. Plug the optional switch cable to 12V 10A output port.
2. Connect the optional switch cable and 12V vehicle product or 12V electronics.
3. Press the switch button to power supply.

LED flash light

Press the switch 3 seconds to start the LED flash light. There are 4 modes of LED light appear in order (normal. strobe. SOS. off) if you press slightly.

C. PARTS LIST:

#	Parts Name	Quantity	#	Parts Name	Quantity
1	Host	1	5	Home adaptor	1
2	Switch cable A	1	6	Car adaptor	1
3	Switch cable B	1	7	Intelligent jumper cable	1
4	Notebook connector	8	8	User Manual	1

D. TECHNICAL SPECIFICATIONS :

Dimension : 225*89*30mm
Weight : 600g
Battery Capacity: 18000mAh(66.6Wh)
Output: 5V=1A;5V=2A;12V=10A;19V=3.5A; 12V jump start
Input: 15V=1A
Full charging time : About 6 hours
Start current : 400A
Peak current : 800A
Operating temperature : -20℃-60℃

④

E. FAQ:

- Q. How to turn off this appliance?
A. This appliance will power off automatically when no load or charging is complete.

- Q. How long time to full charge the EPower?
A. Approx. 6 hours through the 15V 1A input port.

- Q. How many times can this appliance charge for my cell phone?
A. Depend on the battery capacity of your cell phone. Take iPhone6 as an example, can full charging 8 times.

- Q. How long will this appliance on a full charge take to supply the Notebook?
A. 4-6 hours.

- Q. How many times can this appliance jump start the vehicle if it is in full battery?
A. Approx. 40 times.

- Q. What's the lifetime of EPower?
A. Usually 3-5years in normal condition.

- Q. How long does the battery last still can jump start the car after fully charged?
A. 6-12 months, however, we suggest to recharge it every 3 months.

F. TROUBLE SHOOTING:

Finding	Cause	Remedies
No response when pressing the switch button.	Low voltage protection of EPower is started.	Plug the adaptor into the 15V 1A input port to activate
EPower is a bit hot when charging for Notebook.	The charging current is a bit high (3.5A)	Remove the battery of your Notebook and use this appliance to supply power directly, or disconnect EPower with your Notebook and connect them when it is cool.

⑤

G. TOXIC AND HARMFUL SUBSTANCES:

Composition and amount of toxic and harmful substances in EPower.					
Pb	Hg	Cd	Cr(VI)	PBB	PBDE
○	○	○	○	○	○
○ : Indicate all homogeneous materials' hazardous substances content are below the MCV limit specified in the Standard 2002/95/EC(RoHs).					

H. Warning:

- 1.Read the instruction manual carefully before using this unit.
- 2.Jump for 12V vehicles only, it would be hazard if for other jumping. It is forbidden to use for other machines such as aircraft, ship and so on.
- 3.Cauton while using this unit.
- 4.DO NOT use this unit if any cable clamp or cord is damaged.
- 5.DO NOT use in place of a vehicle battery.
- 6.DO NOT use as a battery charger.
- 7.Never remain the unit on car battery after cranking the car success.
- 8.Use the jumper cable provided with this unit only.
- 9.Make sure the BLUE plug of the jumper Cable is plugged fully into jumping socket. Otherwise, the blue plug would be melted.
- 10.Make sure to check all the battery connections are CLEAN before Jump Starting! Make sure the battery clamps are well connected! If the battery terminals on the vehicle are dirty or corroded, the power of the unit will be lessened.
- 11.Do NOT Jump Start more than 3 times in a row. It could damage the unit by overheating. Give two minutes between attempts. The jumping cable can become overheated and detach as a safety measure.
- 12.Remove the product from the vehicle battery within 30 seconds of Jump Starting. If not, it could lead to damage.
- 13.Do NOT connect the two clamps together.
- 14.Only jump start when 3 to 4 indicator lights are illuminated.

⑥

- 15.Do NOT use by young or infirm persons without supervision.
- 16.Do NOT use as a toy.
- 17.Do NOT allow the product to become wet.
- 18.Do NOT immerse the product in water.
- 19.Do NOT operate the product in explosive atmospheres, such as in the presence of flammable liquids, gases or dust.
- 20.Do NOT modify or disassemble Epower. Only a repair technician may repair this unit.
- 21.Do NOT expose product to extreme heat or fire.
- 22.Make sure someone should be within range of your voice or close enough to come to your aid when working with batteries.
- 23.Remove personal metal items like rings, bracelets, necklaces, etc. When using the products.
- 24.Do NOT drop unit. If unit receives a sharp blow or is otherwise damaged in any way have it checked by a qualified battery technician.
- 25.Do NOT store in locations where the temperature may exceed 70℃.
- 26.Charge only at ambient temperature between 0℃ and 60℃.
- 27.Charge only using the charger provided with this unit.
- 28.Do NOT use the unit to jump start a vehicle while charging the internal battery.
- 29.If this unit is leaking liquid dispose of at proper recycle facility immediately.
- 30.Under extreme conditions, battery leakage can occur. If a liquid is noticed coming from product do not handle with bare hands. In case of skin contact wash with soap and water immediately. If liquid comes in contact with eyes rinse eyes with cold running water for at least 10 minutes and get medical attention immediately.
- 31.Product contains lithium based battery, at end of product life dispose of product according to local regulation.

⑦

I. WARRANTY INFORMATION:

1.We offer a limited warranty for this product against any defects in material and workmanship for a period of 6 months from the date of purchase by the end user/consumer. The conditions of the warranty are as follows:

2.The warranty is only valid upon presentation of the original receipt (from dealer/retailer) by the original purchaser with the product to be repaired or replaced.

3.The warranty is void if the serial number, date of purchase and label has been removed.

4.The warranty does not cover damage or product failure resulting from normal wear and tear, physical abuse, improper installation, misuse, modification or repairs by unauthorized third parties.

5.We do not assume responsibility for any loss or damage incurred during shipment or as a result of a force majeure.

6.We are not liable for any incidental or consequential damages arising from the use or misuse of this product.

7.All warranty claims are limited to repair or replacement of the defective product and at the sole discretion of us.

8.If we repair or replace the product, the product will be covered for the remaining time of the original warranty period. Repair or replacement may involve the use of reconditioned units which are equivalent in function. Replaced part or product becomes the property of us.

9.Consumable components such as batteries are not covered by the warranty.

The switch cables coming with the unit for testing ONLY, no commercial value, all rights reserved for the original designed company.



Applied Standard : GB/T 18287-2000

The product is insured by Everest National Insurance Company

⑧

93*130mm