

# FITTING INSTRUCTIONS

Ford Ranger/Mazda BT50 – T7F704



<b>Max Towing Capacity:</b> 3500Kg	<b>Towbar Weight:</b> Approx. 30Kg
<b>Max Ball Load:</b> 350Kg	



## Tools Required:

Spanners/Sockets, Torque Wrench

Kit Contents					
Item	Description	Qty	Item	Description	Qty
1.	Towbar Centre Section	1	12.	M12 Flat Washer	28
2.	End Plate Subassembly PS	1	13.	M12 Shake Proof Washer	18
3.	End Plate Subassembly DS	1	14.	M10x35x1.5 Bolt	4
4.	M12x35x1.75 Bolt on Wire	2	15.	M10 Shake Proof Washer	4
5.	Spacer 3mm	2	16.	M10 Flat Washer	4
6.	Chassis Top Plate	2	17.	TAG Hitch Collar Cover	1
7.	Bumper Spacer	2	18.	Class 4 Pin & Clip	1
8.	M12x45x1.25 Bolt	8	...	Door Sticker	1
9.	M12x1.25 Nut	8	...	Spare Compliance Sticker	1
10.	M12x35x1.75 Bolt	8	...	D-Shackles	2
11.	M12x1.75 Nut	6	...	...	...

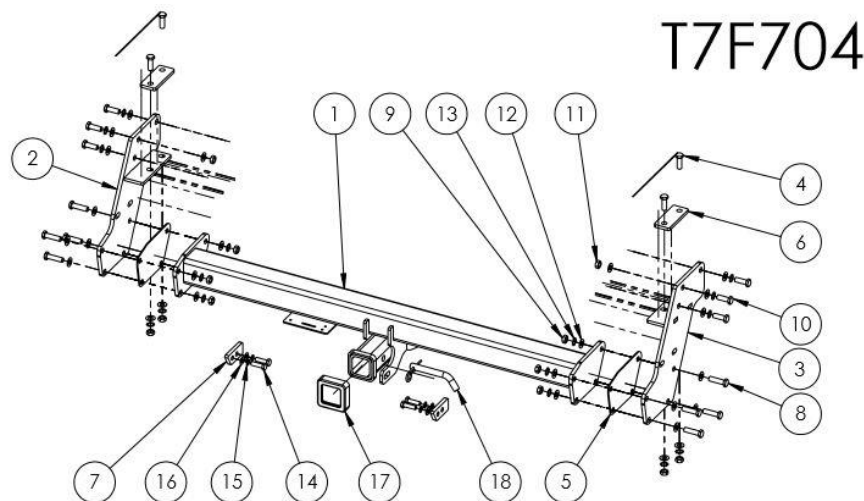

## Warning:

- This product is for towing purposes only and must only be loaded as shown in your vehicle Owners Manual.
- This towbar is NOT to be drilled, cut, welded or modified in any way.
- Check behind chassis rail and body panels before drilling to ensure no hazards are present

## General:



- Before fitting this towbar read fitting instructions and check installation hardware is correct.
- Check that the towbar is suitable for the vehicle and be wary of any changes to the vehicle design that may conflict with the fitting of this towbar.
- After drilling, blow any filings clear, remove any swarf and treat exposed metal with a rust inhibitor.
- If this vehicle requires a bumper cut out, please check to make sure that you measure twice and check twice before cutting any panels as some bumper profiles can change. If you are not sure, then please ask your towbar supplier

# FITTING INSTRUCTIONS

Ford Ranger/Mazda BT50 – T7F704



Step 1	Remove Rear Step	
		
<b>Instructions</b>	<b>Tools</b>	<b>Fasteners/Torques</b>
<p>Disconnect any wiring attached to the rear step. Remove 3x bolts securing the rear step on each chassis rail. Discard of the bolts.</p> <p>Lower spare tire if more room is required.</p> <p>With 2 people supporting the rear step, remove rear step from the vehicle, carefully set aside.</p>	Spanners/ Sockets	N/A

Step 2	Widen brackets on Rear Step	
<p style="text-align: center;"><b>Ranger:</b></p> 	<p style="text-align: center;"><b>BT-50:</b></p> 	
<b>Instructions</b>	<b>Tools</b>	<b>Fasteners/Torques</b>
<p><b>For Ranger:</b> Loosen the 2 bolts connecting the rear step to each of the brackets. Slide each bracket outward by approx. 10mm. Re-tighten the bolts.</p> <p><b>For BT-50:</b> Remove the brackets from the rear step. Install the bumper packers between the rear step and the brackets, secure using M10 hardware as supplied.</p>	Spanners/ Sockets	N/A

# FITTING INSTRUCTIONS

Ford Ranger/Mazda BT50 – T7F704



Step 3	Attach Towbar End Plates & Refit Rear Step		
<b>Instructions</b>	<b>Tools</b>	<b>Torques</b>	
<p>Loosely secure both towbar end plates to the chassis &amp; refit the rear step in the following order.</p> <ul style="list-style-type: none"> <li>- Using 1x M12x1.75x35 Bolt on Wire &amp; 1x M12x1.75x35 Bolt downwards through the Top plate and vertical hole in each chassis rail. Secure with Flat Washers, Shake Proof Washers and M12x1.75 Nuts.</li> <li>- With 2 people carefully lift the rear step into position and secure using 3x M12x1.75x35 Bolts, Flat and Shake Proof Washers, through the towbar end plates into the remaining captive nuts on the outside of each chassis rail. Note there is no captive for the middle bolt, this will require a nut and washer on the inside of the chassis rail</li> <li>- Ensure the rear step is centred, level and at correct height on the vehicle</li> <li>- Reconnect any wiring that has been disconnected</li> </ul> <p>Tighten the bolts to hold the end plates against the chassis rails. <b>DO NOT tighten to torque spec.</b></p>	<p>M12 Spanners/ Sockets</p>	<p>N/A</p>	

Step 4	Determine if Spacers are required		
<b>Instructions</b>	<b>Tools</b>	<b>Fasteners/Torques</b>	
<p>Position the Towbar centre section between the two end plates.</p> <p>If there is more than approx. 3mm clearance between the parts on each side, then spacers will be required.</p> <p>If the clearance is less than this, spacers will not be required between the parts.</p>	<p>N/A</p>	<p>N/A</p>	

# FITTING INSTRUCTIONS

Ford Ranger/Mazda BT50 – T7F704



Step 5   Secure Towbar Centre Section and Torque Bolts		
Instructions	Tools	Fasteners/Torques
<p>Using 4x M12x45 Bolts, Shake Proof Washers and Nuts, 8x M12 Flat Washers, and 1x Spacer (if required) per side. Bolt head should be on the outside and shake proof washer should be on the inside of the flange. Loosely secure the towbar centre section between the end plates. Ensure centre section is right side up with the hitch receiver bellow the main cross-bar. When all hardware is in place, tighten <b>all</b> bolts (including those into the chassis rails) to the torque specified.</p>	<p>M12 Spanners/ Sockets -Torque Wrench</p>	<p>M12 = 100Nm</p>

Step 7   Apply Sticker to Door Jam		
Instructions	Tools	Fasteners/Torques
<p>Apply Towbar info label to the inside of the driver's side door Jam.</p>	<p>N/A</p>	<p>N/A</p>

# FITTING INSTRUCTIONS

Ford Ranger/Mazda BT50 – T7F704



## WARRANTY STATEMENT

The manufacturer of TAG branded products, warrants your TAG Towbar for its full product life under the following conditions:

- You can show proof of purchase.
- The towbar has been correctly installed by a suitably qualified installer.
- The towbar has not been modified or abused in any way and has only been used for the purpose intended.
- The towbar was not fitted second hand to your vehicle.

The extent of this warranty includes materials and workmanship used in the manufacture of the towbar and is to the equivalent value of current, full replacement cost.

Nothing stated or implied in this warranty limits in any way, the statutory rights that you may have.

To make a claim visit the original installer in the first instance or, if you are unable to or are not satisfied with their help, then contact us direct by phone on 07 3208 3022 or via email [qldsales@arandatowbars.com.au](mailto:qldsales@arandatowbars.com.au)